

Syllabus for the Engineering Drawing Basics

Section 1: Intro to Engineering Drawings

- Types of Drawings and How They're Used
- Goal of an Engineering Drawing
- Most Important Parts of the Drawing

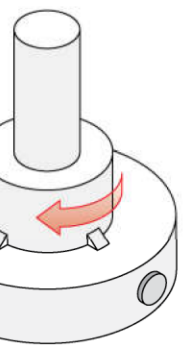

Section 2: Parts of a Drawing

- Field of View
- Title Block
- General Drawing Notes
- Revision Block
- Bill of Materials
- Exercises - Parts of a Drawing

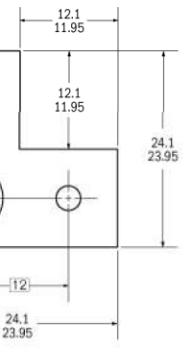

Section 3: Understanding Engineering Graphics

- Part Geometry Lines
- Orthographic Views - 2D Print to a 3D Part
- Exercises - Orthographic Views
- Common Drawing Views
- Types of Section Views
- Descriptive Lines
- Exercises - Understanding Drawing Views

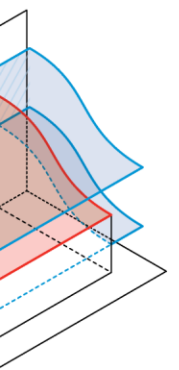

Section 4: Tolerances & Dimensions

- Intro to Part Tolerances
- Types of Dimensional Tolerances

Lessons Coming Soon - Available May 2020**

- *Metric VS. Inch Dimensions*
- *Dimensioning Methods*
- *Interpreting Dimensional Tolerances - Exercises*
- *Intro to GD&T*
- *GD&T vs Coordinate Tolerancing - Examples*

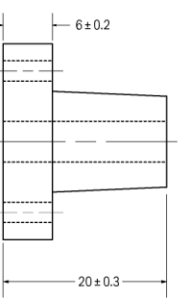

Copyright © 2020 Pareto Learning LLC

